

Cone

Robe Hook 6874-52-80CP

INTRODUCTION:

The double hooks with smooth line shows the symmetric beauty, raising its quality to artistic level. Having advantage of durability and functionality, it would make household livings more comfortable.



DESCRIPTION:

- 1.Brass forging mounting base meets JIS 3771 standard.
- 2.Brass hook meets JIS 3604 standard.
- 3.Justime finishes resist corrosion and tarnish.
- 4.Chrome plated finish meets the standard of ASTM-SC2.
- 5.Vertical force could support a static load of 5 Kgf.
- 6.Equipped with stainless steel screws to secure installation.
- 7.Double hooks improve the convenience.
- 8.Coordinates with other products in 6874 collection.

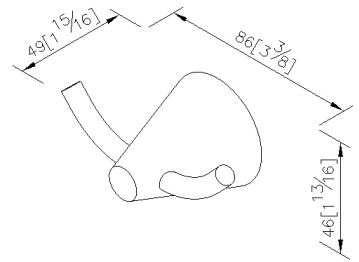

unit:mm[inch]

Certification:

Fixing Kits:

- 1.SUS 304 Stainless Steel Screws*2
- Plastic Anchors*2
Material of Wall Mount Bracket: Steel with zinc plating*1

AWARD: