

Swivel Double Towel Bar 6880-12-80CP

INTRODUCTION:

Cylinder is widely applied to both oriental and western architectures as columns, so people would have an impression of great reliability on the cylindrical objects. Inserting this concept into our products, we have created elegant bathroom brasswares that are highly durable. The swivel towel bar provides double hanging space in an elastic way, making household living more convenient.

DESCRIPTION:

- 1.Brass of forging mounting base and bracket meet JIS 3771 standard.
- 2.Brass cylinder and towel bar meet JIS 3604 standard.
- 3.Justime finishes resist corrosion and tarnish.
- 4.Chrome plated finish meets the standard of ASTM-SC2.
- 5.Vertical force could support a static load of 4 Kgf.
- 6.The towel bar could be swiveled by user request and be flexible to your bathroom space.
- 7.Coordinates with other products in 6880 collection.

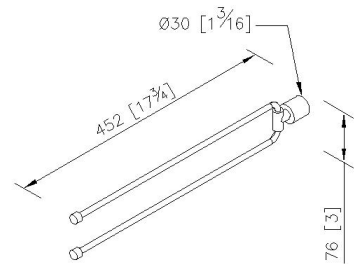

Certification:

Fixing Kits:

- SUS 304 Stainless Steel Screws *2
- Hex Key 1/8" *1
- Plastic Anchors *2

AWARD: