

Tooth Brush Holder
6922-35-80CP

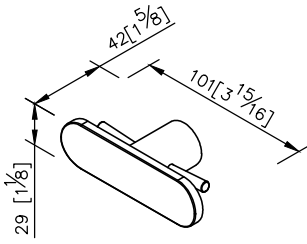

unit: mm[inch]

- 1.Brass meets JIS 3604 standard.
- 2.Premium metal construction for durability.
- 3.Justime finishes resist corrosion and tarnish.
- 4.Chrome plated finish meets the standard of ASTM-SC2.
- 5.Product has been designed without joints to make it easy to clean.
- 6.Vertical force could support a static load of 2 kgf.
- 7.The sticks of two sides for placing tooth-brush with 4 degrees upward tilt is a considerate idea for keeping tooth-brush on the holder.
- 8.Coordinates with other products in Charming collection.

